

PLAN- TOP SLAB

#6 @ 5' O.C. E-W
1.5" FROM BOTTOM

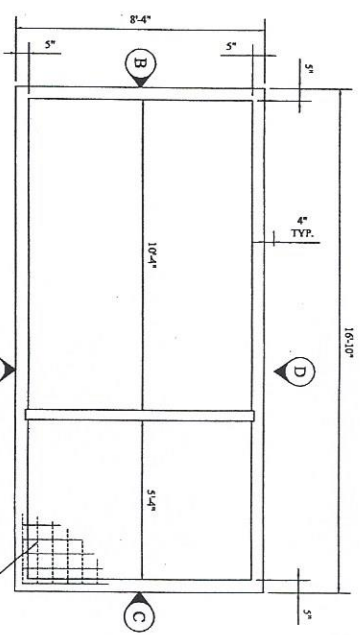

PLAN- BOTTOM SLAB

TYP. BASE REINF.
#5 @ 10' E-W
CTR. IN BASE



I HEREBY CERTIFY THAT THIS PLAN, SPECIFICATION OR REPORT WAS PREPARED BY ME OR UNDER MY DIRECT PERSONAL SUPERVISION AND THAT I AM A DULY LICENSED PROFESSIONAL ENGINEER UNDER THE STATUTES OF THE STATE OF MICHIGAN.

ERIC HORLYK
DATE: 3/8/2012
MY REGISTRATION EXPIRES 31 DECEMBER 2013
SHEETS COVERED: 13

REG. NO. 103982

CONCRETE AND REINFORCING GRADATIONS DESIGNED FOR H20 LOADING

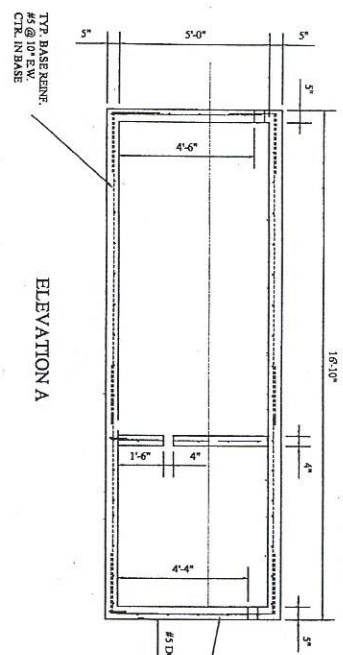

ELEVATION A

TYP. BASE REINF.
#5 @ 10' E-W
CTR. IN BASE

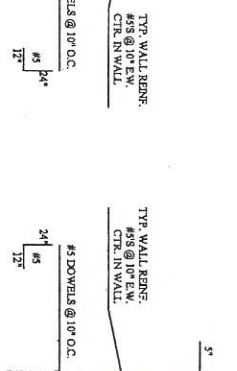

ELEVATION B

TYP. WALL REINF.
#5 @ 10' E-W
CTR. IN WALL

#5 DOWELS @ 10' O.C.

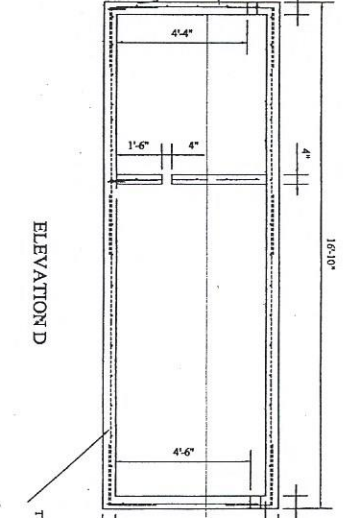

ELEVATION C

TYP. WALL REINF.
#5 @ 10' E-W
CTR. IN WALL

#5 DOWELS @ 10' O.C.

ELEVATION D

TYP. BASE REINF.
#5 @ 10' E-W
CTR. IN BASE

ADVANCED ENGINEERING INC.

LISTER INDUSTRIES

DATE: 3/8/2012

4000 GAL. GREASE TRAP